

69600S - XXX X X X X X

REV	DESCRIPTION	BY	DATE
-	PRODUCTION RELEASE;ECN-52102	RCH	7/26/13

<b>SIZE:</b> SEE CHART	<b>MEDIA:</b> [H] HEPA 99.99% [4] HEPA 99.995% [U] ULPA 99.9995% [S] ULPA 99.99999%	<b>CONSTRUCTION:</b> [A] ALUMINUM [P] PAINTED [S] STAINLESS	<b>SCREEN:</b> [P] PAINTED [S] STAINLESS [L] PLASTIC [Z] PAINTED ALUMINUM	<b>INDICATOR LIGHT</b> [I] INDICATOR LIGHT [X] NONE	<b>CHALLENGE PORT</b> [C] CHALLENGE PORT [X] NONE
---------------------------	---	--	---	---	---

CODE	NOMINAL SIZE	DIM. "A"	DIM. "B"
[001]	2X4	23.625	47.625
[002]	2X3.5	23.625	41.625
[003]	2X3	23.625	35.625
[004]	2X2	23.625	23.625
[005]	2X4	23.125	47.125
[006]	2X3.5	23.125	41.125
[007]	2X3	23.125	35.125
[008]	2X2	23.125	23.125
[009]	2X4	23.000	47.000
[010]	2X3.5	23.000	41.000
[011]	2X3	23.000	35.000
[012]	2X2	23.000	23.000
[013]	585X1185	23.032	46.654
[014]	585X1035	23.032	40.748
[015]	585X885	23.032	34.843
[016]	585X585	23.032	23.032

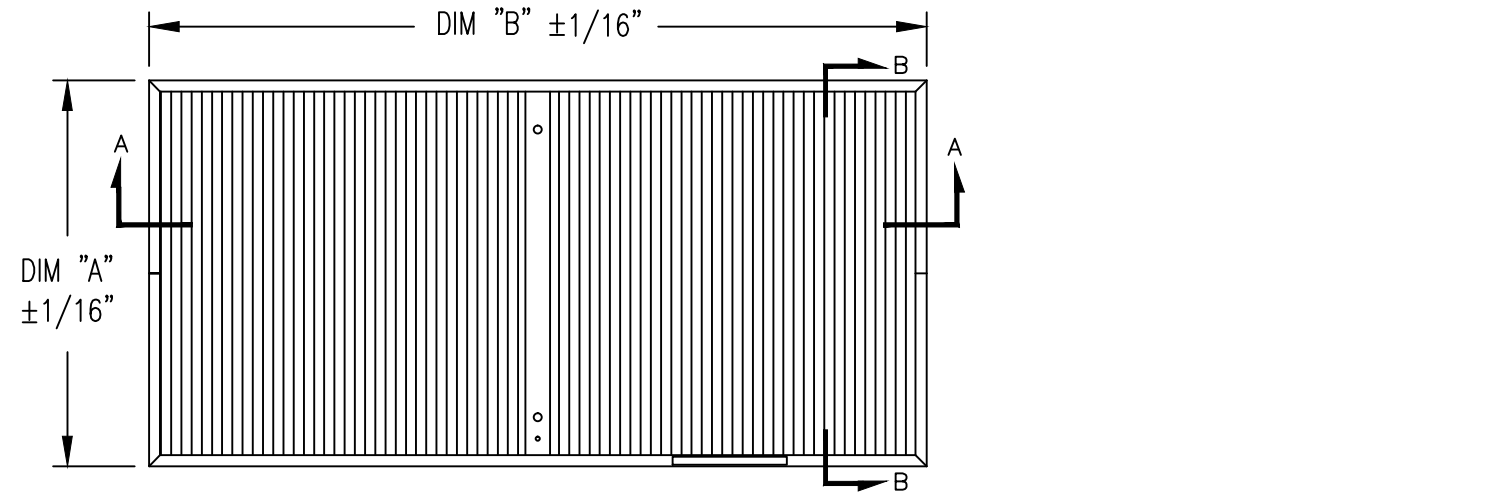

TOP VIEW

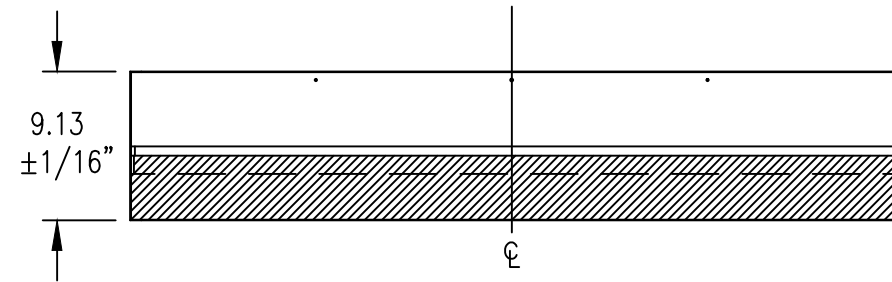

SECTION A-A

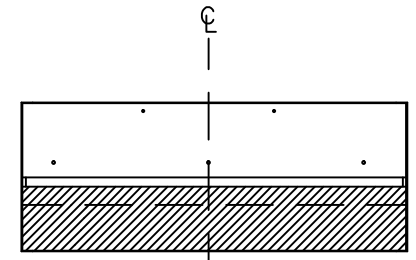

SECTION B-B

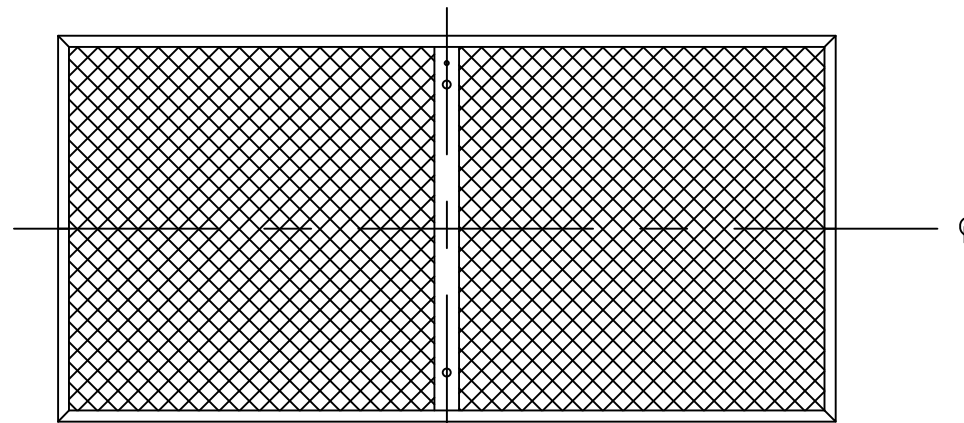

BOTTOM VIEW

**NOTES:**

- FILTER MEDIA: MICROGLASS FIBER WITH ACRYLIC LATEX BINDER
- PLEAT DEPTH: 3" OR 53 MM PLEAT
- EFFICIENCY:
  - H= HEPA = 99.99% EFFICIENT @ 0.30µm (IEST-RP-C007)
  - 4= HEPA = 99.995% EFFICIENT @ 0.20µm (IEST-RP-C007)
  - U= ULPA = 99.9995% EFFICIENT @ 0.12µm (IEST-RP-C007)
  - S= ULPA = 99.99999% EFFICIENT @ 0.12µm (IEST-RP-C007)
- RESISTANCE:
  - H= HEPA = 0.45" ±0.02" W.G. AT 100 FPM (715 CFM)
  - 4= HEPA = 0.50" ±0.02" W.G. AT 100 FPM (715 CFM)
  - U= ULPA = 0.52" ±0.02" W.G. AT 100 FPM (715 CFM)
  - S= ULPA = 0.62" ±0.02" W.G. AT 100 FPM (715 CFM)
- SEPARATOR MATERIAL: PER MANUFACTURES SPEC
- FRAME MATERIAL: ANODIZED ALUMINUM
- GRILLE MATERIAL: EXPANDED METAL PAINTED WHITE
- SEALANT MATERIAL: FIRE RETARDANT TWO-PART URETHANE
- EFFICIENCY TEST:
  - HEPA = TYPE J FILTER (IEST-RP-C034)
  - ULPA = TYPE F FILTER (IEST-RP-C034)
- FIRE RATING: GRADE 4 UL-900

DIMENSION ARE IN INCHES		MATERIAL:		<b>TRION</b> ® PROPERTY OF TRION, SANFORD, NC 27330			FILTER - MAC10 STD, SUBMITTAL	REV					
TOLERANCES-UNLESS OTHERWISE SPECIFIED								SCALE					
.X OR X/X ±.05	CONC .005 TIR	SHEAR SIZE	SQ FT	U/M	DRW	RCH	CRG	RCH	APP	DAR	DWG	8000011	1/1
.XX ±.03	BEND RAD: DWG 122223												
.XXX ±.015	FINISH: NONE												
ANGULAR ±1°	REMOVE BURRS AND SHARPS												
					7/26/13	7/26/13	7/26/13						