

TIP CLEANER

FT-720

Instruction Manual

Thank you for purchasing the HAKKO FT-720.

This product is a rotating tip cleaner.

Before using this product, be sure to read this manual.

Keep this manual readily accessible for reference.

1. Contents and Part Names Confirm the contents before use.

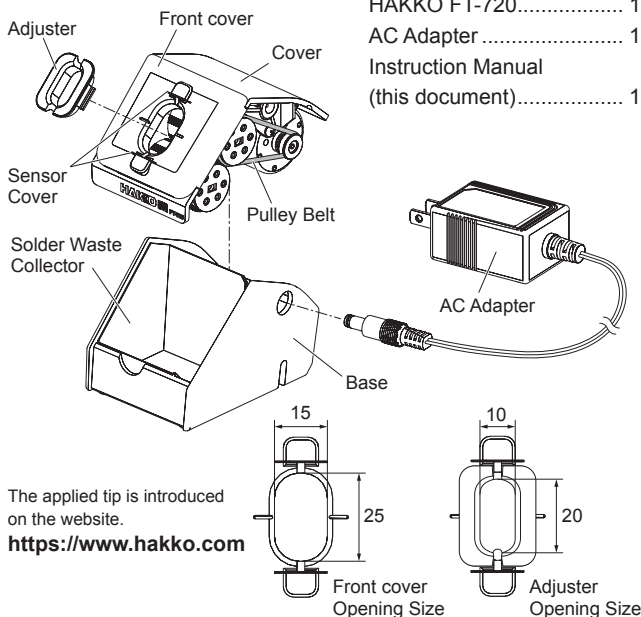

2. Specifications

● HAKKO FT-720

Rating	24 VDC 140 mA
Brush rotational speed	1670 rpm
Dimensions	67 (W) × 63 (H) × 94 (D) mm (2.6 × 2.5 × 3.7 in.)
Weight	200 g (0.44lb.)

● AC Adapter

Output voltage	24 VDC
----------------	--------

* This product is applied with electrostatic countermeasures.

* Please note that specifications and appearance are subject to change without notice in the interest of product improvement.

⚠ CAUTION

■ Handling precautions for ESD Safe products

This product contains electrostatic countermeasures, so please use the following precautions:

1. Not all plastic parts are insulators, they may be conductive. Be careful not to expose live electrical parts or damage insulating materials when performing repairs or replacing parts.
2. Be sure to ground the product before use.

※ 各言語（日本語、英語、中国語、フランス語、ドイツ語、韓国語）の取扱説明書は以下の URL、HAKKO Document Portal からダウンロードしてご覧いただけます。（商品によっては設定の無い言語がありますが、ご了承ください。）
 * 各言語（日本語、英語、中文、法語、ドイツ語、韓国語）の使用説明書可以通过以下网站的 HAKKO Document Portal 下载参阅。（有一部分的产品没有设定外语对应、请见谅）
 * Instruction manual in the language of Japanese, English, Chinese, French, German, and Korean can be downloaded from the HAKKO Document Portal. (Please note that some languages may not be available depending on the product.)

➔ <https://doc.hakko.com>

3. Warnings, Cautions, and Notes

Warnings, cautions, and notes are placed at critical points in this manual to direct your attention to significant items. They are defined as follows:

- ⚠ WARNING: Failure to comply with a WARNING may result in serious injury or death.
 - ⚠ CAUTION: Failure to comply with a CAUTION may result in injury to the operator, or damage to the items involved.
- Note: This indicates procedures or information that are important in a process described in this document.

Be sure to observe the following precautions to ensure safety.

⚠ WARNING

- Those without the permission of a manager and those without the required experience or knowledge (including children) are not allowed to use this product.
- Do not allow children to play with this product.
- Do not allow children to clean or perform user maintenance without supervision.

Failure to observe the following precautions to ensure safety might result in electric shock, malfunction or other trouble.

⚠ CAUTION

- Before using this product, fully read all descriptions in this document.
- Do not use this product as an iron stand.
- Be sure to install the solder waste collector before use.
- Be sure to attach the front cover and sensor cover before use.
- When carrying the cleaner, carrying it by holding the base and not the AC adapter plug.
- This product is for indoor use only. Do not use it outdoors.
- When this product is not used for a long time, or before repairing or cleaning this product, disconnect the AC adapter plug from the power outlet.
- When replacing parts, use only genuine HAKKO parts.
- Use only the AC adapter that is included in the set. Do not use other AC adapters.
- Do not modify this product.
- When inserting and removing the plug, hold the plug body and do not pull the cord.
- Do not allow this product to get wet. Also, do not handle it with wet hands.
- Do not perform any other actions that may be considered dangerous.

4. Operation

- (1) Insert the AC adapter plug in the DC jack.
- (2) The sensor reacts when the tip is inserted and cleaning will begin.

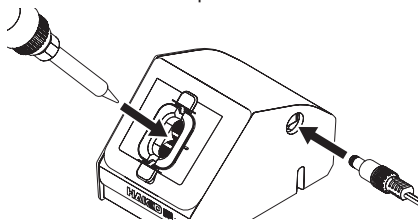

- Note** Do not intentionally rotate the brush continuously.
- Note** Remove the adjuster when using a large tip. The adjuster can be stored in the base.
- Note** This product cleans the tip in a short time. If the tip is left in for a long time, it may accelerate deterioration of the tip or the cleaning brush.
- Note** Place this product on grounded surface with electrostatic measurement, or connect a wire to the ground screw upon use.

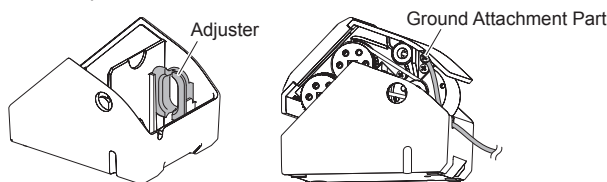

5. Maintenance

CAUTION

Regularly remove solder waste and flux residue that adhere to the solder waste collector, cleaner interior, and cleaning brush.

- Note** To remove the cover you must first remove the AC adapter plug from the DC jack.

- **Removal of Solder Waste**
Remove the cover and remove solder waste.

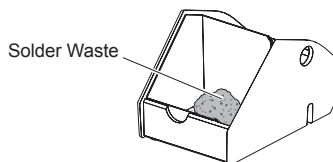

- **Replacing the Brushes**
Replace the cleaning brushes by pulling them straight out of their brush fixing shafts.
* Tools are not required.

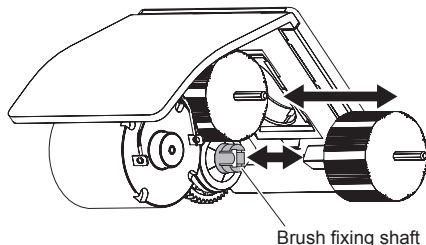

- **Cleaning the Sensor Cover**
Remove stains on the upper and lower recess areas of the front cover using a soft brush.

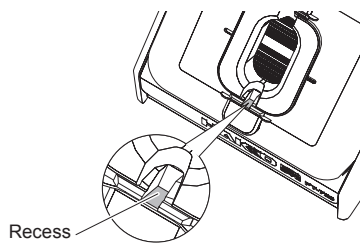

- Note** If the sensor cover is considerably stained, remove the sensor cover and clean it with alcohol damp cloth. In this case, be careful not to let solder waste or other debris fall into the device.
- Note** Replace the sensor cover if it has cracked or there is a considerable amount of scratches.

6. Troubleshooting

The cleaning brush continues to rotate.	Is the front cover or adjuster bent or out of alignment?	▶ Attach it in the correct position.
	Is the sensor cover stained?	▶ Please clean it.
The motor does not move.	Are the AC adapter and plug connected?	▶ Connect.
The motor moves but the cleaning brush does not rotate.	Has the pulley belt come off?	▶ Reattach it.

When other problems occur or the above remedies do not resolve a problem, contact your nearest agent.

7. Parts List

Replacement Parts

Part No.	Part Name	Specifications
A5063	Cleaning brush C	Fluoroplastic brush, qty 2
A5060	Front cover	With sensor cover
A5061	Adjuster	
A5062	Sensor cover	qty 10
B5284	Pulley belt	
B3528	AC adapter	Flat pin plug
B5118	AC adapter	Chinese plug
B5119	AC adapter	BS plug CE
B5120	AC adapter	European plug CE
B5121	AC adapter	Australian plug

Options

Part No.	Part Name	Specifications
A1566	Cleaning brush A	Plastic brush, qty 2
A1567	Cleaning brush B	Metal brush, qty 2



HAKKO CORPORATION
HEAD OFFICE

4-5, Shiokusa 2-chome, Naniwa-ku, Osaka 556-0024 JAPAN
TEL: +81-6-6561-3225 FAX: +81-6-6561-8466
<https://www.hakko.com> E-mail: sales@hakko.com

Please access the web address below for other distributors.

<https://www.hakko.com>

2022.1